

# PINTLALA HISTORICAL ASSOCIATION

**Next Meeting:**  
*January 15th—2:30 p.m.*  
Pintlala Baptist Church



*c/o Pintlala Public Library  
255 Federal Road  
Hope Hull, Alabama 36043*

Volume XXVI, Number 1

[www.pintlalahistoricalassociation.com](http://www.pintlalahistoricalassociation.com)

January 2012

## **Pintlala Elementary School, circa 1920s**



### **2012 OFFICERS**

President.....Gary Burton ..... (334)288-7414  
Vice President .....Lee Barnes ..... (334)288-4855  
Secretary .....Karon Bailey ..... (334)281-6239  
Treasurer .....Ina Slade..... (334)284-0334  
Parliamentarian.....Jack Hornady..... (334)396-2130  
Program Chairperson.....Alice T. Carter..... (334)281-3708  
Members at Large  
Place 1 .....Jean Dean ..... (334)548-2167  
Place 2 .....Daisy Anne Brady ..... (334)612-0766  
Place 3 .....Rene Barnett ..... (334)288-0231  
Place 4 .....Gregg Linn ..... (334)281-9050  
Newsletter Designer ..... Angelique Pugh

### **TABLE OF CONTENTS**

President's Message .....Page 2  
January Program .....Page 2  
PHA Tax Status .....Page 3  
Federal Road 200th Anniversary .....Page 4  
*The Montgomery Advertiser* Transcription of Mildred  
Smith Article, 1944.....Page 7

## President's Message - "Two Matters"

- The PHA owes Alice Carter a tremendous debt. Since our last board meeting Alice has given untiringly of her time to gather information required by our application for 501c3 status with the Federal government. Once obtained, contributions and gifts will be tax-exempt. Ina Slade, our competent treasurer, has provided years of past financial data for the application. Our organization needs more than membership dues to be effective in accomplishing our mission of preservation and education. Providing programs, recruiting speakers and presenters, four newsletters each year, maintaining our website, and adopting relevant projects from time to time, cannot be sustained on \$15.00 membership dues alone. So the work done by Alice and Ina will position us in strengthening our financial capacity.
- A sense of place is a treasure most people do not have; yet it is essential for a healthy community and responsible citizenship. The National Trust for Historic Preservation offers a straightforward approach, calling a sense of place: *Those things that add up to a feeling that a community is a special place, distinct from anywhere else.* When residents acquire a knowledge of local history, bonding to a community becomes possible. Do you have a sense of place?

Gary Burton, President  
garyburton1@charter.net

---

## January 2012 PHA Program

PHA will meet on January 15th at 2:30 p.m. in the Fellowship Hall of Pintlala Baptist Church. Carole King, Historic Properties Curator at Old Alabama Town for more than 28 years, and Karren Pell, singer-songwriter and teacher of British Literature at Montgomery Catholic Preparatory School, will bring their new book, *Montgomery—Then and Now*, to share with us. This book features photographs of the city from the riverfront to Court Square and lower Dexter Avenue. Images of public buildings, schools, churches and homes are reproduced. They will have copies available for purchase (\$21.99) for those interested in having a published record of early and contemporary Montgomery with comparison photographs. Please attend and bring friends—YOU are important to our organization.



Carol King & Karren Pell autograph books

## IMPORTANT REMINDER

**DUES ARE DUE AT THE JANUARY 15TH MEETING OR YOU MAY MAIL YOUR CHECK TO INA SLADE, TREASURER (ADDRESS ON LAST PAGE). DUES ARE \$15.00 Annually. PLEASE RE-NEW YOUR MEMBERSHIP SO THAT WE DO NOT HAVE TO PAY POSTAGE FOR POSTCARD REMINDERS. THANKS VERY MUCH.**

**WELCOME NEW MEMBERS:** Jack Woods, Lapine; Helen and Hugh Gordon, Hope Hull; Don Sisk, Hope Hull; James Dewitt Garrett, Decatur

## PHA Tax Status

The Executive Board of the PHA has made the decision to seek tax-exempt status for the organization. The lengthy and complicated forms necessary for this status have been mailed to the IRS. Thanks to Mitch Henry and his assistant, Steven Foster of Webster, Henry, Lyons, White, Bradwell & Black, P.C., James Blake of Aldrich, Borden Inc., PHA members, Kerry Brown, Ina Slade and Gary Burton for their assistance with this project.

The Board also voted to accept the offer from Gene Crane to gift our organization with one of the millstones from the Thomas Butler Mill. This mill was located in Montgomery County on what would become the Butler Mill Road. There are many details yet to be arranged in connection with this generous offer.

## Joyce and Bill Nicoll

Longtime PHA members, Joyce and Bill Nicoll, have moved from Alabama to Tennessee to be near their son and his family. Joyce has been active in local historical and genealogical organizations and was particularly active with the Historical Cemetery Preservation groups in Alabama. We thank her for coming to the aid of the McGehee Cemetery in Hope Hull for its second resurrection!

## Reprint of History of Pintlala School

The Executive Board voted to have the History of Pintlala School Booklet reprinted as the result of an order for 15 copies from one person. We had 50 copies made and there are 35 copies available for purchase at the original cost of \$15.00. Call Alice Carter at 281-3708 if you or any of your associates are interested in having a copy.



History of  
Pintlala School  
Pintlala, Alabama

**THE PHA MISSED THE TWO HUNDRETH ANNIVERSARY**

November 30, 1811

The Completion of the Federal Road near Pintlala

---

---

Dr. Kathryn Braund, noted historian who teaches at Auburn University, recently posted the following on Facebook:

ON THIS DAY IN HISTORY....200 YEARS AGO...somewhere near Pintlala, the Federal Road was completed. YES!! Pintlala. The Old Federal Road. Who remembered? Just got an e-mail from Greg Waselkov, who reminded me that this is "the very day those two parties of axe-weilding soldiers met somewhere near Pintlala in 1811, leading to all sorts of strife and woe and nation-building and such." We should have had a party!

---

---

*As a follow-up, Dr. Greg Waselkov, who led the archeological exploration for Manac's Tavern a few months ago, emailed Gary Burton:*

Hi Gary,

Actually it happened on November 30<sup>th</sup>. Peggy Dow's journal gets us in the ballpark, when she says the road was recently finished and she is recuperating from her traverse of the Creek Nation in mid-December 1811 when the earthquakes start up. Grant's edition of *Letters, Journals and Writings of Benjamin Hawkins* fills in the details. A letter to General Wade Hampton dated Aug. 26, 1811 (pp. 590-591) tells us that Hampton is negotiating with the Creek leaders and will direct construction of the road from the east, while a Captain Arbuckle would direct the troops at Fort Stoddert to do the same from the west. A flurry of letters in October and November (p. 597) document the progress from both directions in building bridges and causewaying swamps. On December 2, Hawkins wrote David B. Mitchell (p. 599) that Captain Arbuckle wrote him on November 30 that he and Captain Moore from Fort Stoddert "have this day finished the road and will turn our backs to each other tomorrow." Hawkins says they met 125 miles west of the Creek Agency, which is in the vicinity of modern Montgomery. It might have been a little east of Pintlala, but not too far off.

Warm regards,

Greg

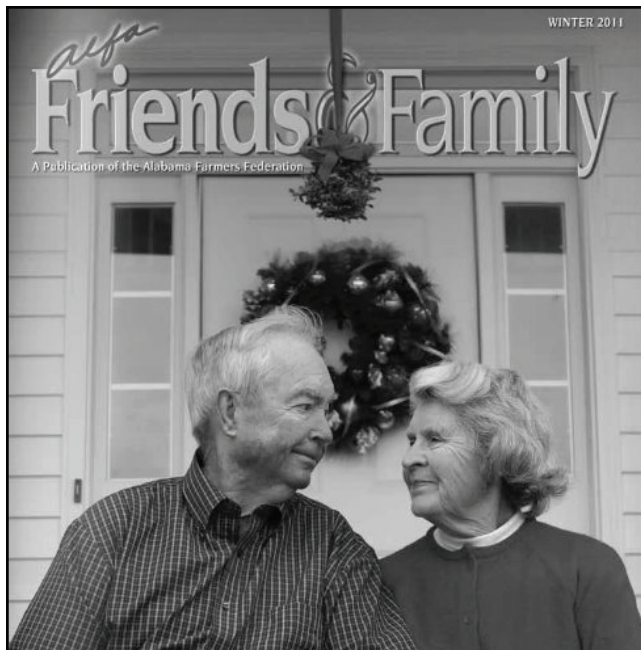

Pintlala's own Davis and Margery Henry were featured in the Winter 2011 edition of *Alfa Friends and Family*. They are featured in the article titled, "The Magic of Mistletoe". The complete edition can be found on Alfa's website, <http://www.alfafarmers.org/friendsfamily/>

### Shackelford Cemetery

The article on the Shackelford Family of Pintlala, which appeared in the April 2011 newsletter was the impetus for having the cemetery that bears their name listed on the Alabama Historical Cemetery Register.



## ALABAMA HISTORIC CEMETERY REGISTER

THIS IS TO CERTIFY THAT

**SHACKELFORD FAMILY CEMETERY**

LOCATED IN MONTGOMERY COUNTY WAS LISTED ON

**OCTOBER 24, 2011**

preserve **ALA**  
ALABAMA HISTORICAL COMMISSION

*Robert Bentley*  
GOVERNOR OF ALABAMA  
*J.R.W. White*  
EXECUTIVE DIRECTOR  
ALABAMA HISTORICAL COMMISSION

Jean Dean was kind enough to share the following at the last PHA meeting.  
Does anyone know anything about the Election House School?

Commencement Exercises  
of  
"Election House High School"  
Le Grand, Ala.  
April 23, 1897.

- (1) Music
- Charriot Race (by Miss Walter)
- (2) Rainbow
- (3) House-keeping
- (4) Billet Doux  
by Lula Lee Underwood
- (5) Margueradina
- (6) Music
- Happy Shepherd's Dream  
by Miss Taylor
- (7) The Rehearsal
- (8) Actions speak louder  
than words.
- (9) Mitchen
- (10) The train to Mauro
- (11) Sono  
Lullaby by Miss Walter
- (12) Japanese Fan Drill
- (13) Presentation of prize

**Transcription from *The Montgomery Advertiser*  
*Montgomery County News – April 10, 1944*  
 By Mildred Smith**

**Ramer, Ala, April 9**-Mutterings of a county correspondent: To every Montgomery County man and woman in the service, Easter greetings from this column today ... Business is prosperous only when people buy the things that tickle their imaginations ... Sale of necessities only would never bring a business boom ... Men's shirts will soon be equipped with glass buttons ... Unable to obtain ocean pearl buttons in necessary quantity, one of the largest and best-known companies will use glass buttons on some lines in future ... Someone has said: "Peace is coming – with plenty of nylons, the women hope, otherwise there will be no peace." ... Mrs. Carlton Newman (Margaret Shellman of Cecil) writes from Midland, Texas of 18 degree weather that killed fruit, vegetables and many flowers and queries what the pre-Easter cold did in Montgomery County ... The Newmans hope to visit in Alabama in July when the man of the family gets his annual furlough under the new ruling at Midland that furloughs are limited to one a year.

Pindale Civic Club makes a gift of supplies to the Red Cross canteen in Montgomery once a week ... A chairman is appointed for each week and other members deliver their contributions to her and she in turn delivers them to the canteen ... More and more of the rural organizations are sending supplies at regular intervals to the canteen ... It is a gesture to the war effort that many can make who cannot participate in other ways ... During the wartime life is attended with more than the usual bothers ... With it possible to eat supper in the United States and breakfast in England, distance is almost outmoded ... The days of the fable's magic carpet that would take you where you wanted to be at the sound of the letters, "ABRACADABRA," seem almost at hand ... Private travel by plane is as inevitable after this war as the Model-T Ford was after the first World War.

The first moving pictures were shown 50 years ago this April when Thomas A. Edison turned over his first 10 machines, which he called kinetoscopes, to Thomas Lombard, who set up a movie in a former shoe store on Broadway in New York ... Incidentally, that first film parlor is a shoe store again today ... Edison's lawyer wanted to patent the machine but when he told Edison it would cost \$150, the inventor declared it wasn't worth it ... But from the modest beginning on April 14, 1894, there has grown an industry operating 17,000 picture shows in the United States and 67,000 in the normal peacetime world.

---

Grange Hall was the name of the original school at Pintlala, located just east of the present building. Tommye Jean Sellers of Mt. Carmel community, turning editorialist in a recent edition of the Ramer High School news bulletin, wrote. Seven schools were consolidated to make Pintlala, she says, Grange Hall, Fleta, Mt. Carmel, Bethlehem, LeGrand, Hope Hull and Tabernacle. Ben S. Copeland was the first principal. Mrs. Mineola King Sellers, who was principal of the old school, became one of the capable teachers of this consolidated school.

"Who remembers Pintlala without Miss Kittye (Mrs. P. H. McIntyre) but who wants to call her that. This is her 22<sup>nd</sup> year. She has done a good job, even giving the right kind of yank to some tot's hair just to make him stay in his desk. Do you remember your yank?" the editorial continues.

Tommye Jean also recalls that Mrs. Mary McLean White had two eyes in the back of her head. "We can see her now," she says, "stately and dignified, writing on the board and seeing everything in the room. This is her 16<sup>th</sup> year. Her pass words were thoroughness and thrift. Her sister, Miss Laura McLean, is in her 15<sup>th</sup> year of teaching."

L. R. Scarborough succeeded Mr. Copeland as principal, she continues, but does not give the number of years he has taught at Pintlala because "he would consider it a clue to his age, and is a little bashful on the subject."

"It is obvious that a blush can be seen on the top of his head," she writes, "so why not estimate his age by the spread of the blush?" Be that as it may, by the help of his paddle with a hole in it, he has turned out some outstanding products."

---

What's happening in the county this week:

Pike Road Junior 4-H Club will meet Monday at 10:20 a.m. at the school, having been postponed from last week. The senior club, also postponed from last week, will meet Monday at 11:15 a.m.

The W. S. C. S. of Snowdoun Methodist Church will meet Monday at 2:30 p.m. at the home of Mrs. W. E. Jones.

Catoma P. T. A. will meet Monday night at the school. Plans will be made for a Summer roundup in April.

---

Hunter Civic Club will meet Tuesday at 2:30 p.m. with Mrs. M. L. Joiner as hostess.

Pindale Civic Club will hold its annual birthday party Tuesday at 3 p.m. at the home of the president, Mrs. Bernie Brannen, with the Crossroads group as hostesses.

Chisholm 4-H Club will meet Tuesday at 11 a.m. at the school.

---

Ramer Elementary 4-H Club will meet Wednesday at the school at 9:30 a.m.

Ramer Junior-Senior 4-H Club will meet Wednesday at the high school at 10:40 a.m.

Snowdoun Woman's Club will meet Wednesday at 2:30 p.m. at the home of Mrs. R. W. Erke with Mrs. Roy Glass assisting hostess. Roll call will be answered with favorite proverbs.

Ramer P. T. A. postponed from last week, will meet Wednesday at 2:45 p.m. in the sixth grade room.

---

Mt. Carmel Civic Club will meet Thursday at 2:30 p.m. at the club house with Mrs. Fannie Chambers, Mrs. C. M. Dean, and Mrs. Clyde Beck as hostesses.

---

Ramer Dramatic Club will meet Friday at the high school.

Pintlala 4-H Club, postponed from last week, will meet Friday at 10:45 a.m. at the school

Cleveland Avenue Extension 4-H Club will meet Friday at 4 p.m.

---

Montgomery County in the service: I think the boys out on the firing line have a crucible in which they are measuring those of us back here at home and I also think they are beginning to feel tired of war and anxious to get the job over and come home as soon as it can be done. When you have read a letter from Thomas Chesnutt, of Pintlala community, to this column a few days ago, you will see what I mean, and you will have tears in your eyes just as I did. Now a radio mate, 2<sup>nd</sup> class, on a warship, Thomas has been in the States only a few weeks since he enlisted two years ago and has not been home at all. He wrote on March 29:

"Greetings once again. No mail has been delivered our way in many weeks but that isn't anything new; sometimes a couple of months or more drift by before the postman begins to feel sorry for us and comes across with our mail. Even though at no time lately have I received a message with your name attached, I feel as if a message was delivered from you in the few letters from some of the old gang telling me something you had to say about us in the paper. As we have had no mail lately I don't know what it was but it was well to know we had a grand person like you pulling for us while we are away out here. We don't appreciate those who can't back us by not sticking. What would they say if part of the army, marines and navy refused to fight the Japs? They would be the first to sound off with 'Traitor, shoot him.' That's what we think of them, only worse. But what the heck? There is every thing in the war but things that make sense.

"What does that wonderful State, Alabama, look like these days? It has been nearly two years since I shoved out of Montgomery to become a part of the navy and all but one and a half months has been on board ship. During this time I have spent a few weeks in California and a very few days in Australia and dozens of other places but not one day in Alabama. That's the place I miss most and nothing is



going to prevent me from returning there some day to really enjoy life. I never knew things were so beautiful there until I saw what the other part of the world had to offer – nothing as far as I'm concerned.

"I went ashore the other day for the first time in many weeks and actually came back with mud (had almost forgotten what mud was) on my shoes. It also seemed strange for the land to stay in one spot. We eat, sleep, read and write with that continuous rolling and rock of the ship. Australia was swell and the people were grand to us and many of the fellows fell in love, but all mine is definitely in Alabama.

"Tell all hello for me and one of these days there will be a celebration right when all the gang is back and I'm going to eat fresh fruits and vegetables, mother's homecooked food, and drink fresh milk for at least 10 hours a day the first six months. We have gone for 10 months without fresh milk or many fruits, or seeing girls, or other white people except sailors. Don't get the idea Navy food is no good. We had the best that can be gotten down this way and ice cream every other day (we didn't have any ice cream until two months ago) but it just isn't that homecooked food of mother's."

Thomas closes his letter by saying: "You've been a swell listener. Thanks." I shall write him that all the readers of this column have been swell listeners, too.

First Lieut. Francis R. Lawson, 20-year-old son of Mr. and Mrs. Sidney Lawson of Cecil community, received news of a promotion in rank and recorded his first confirmed victory over the Luftwaffe on the same day, March 11, when he led a flight of P-38's escorting heavy bombers to Toulon, France. Pilot of a P-38, Lieut. Lawson stepped from the cockpit of his plane to be greeted with the news that orders promoting him to the rank of first lieutenant as of Feb. 26 had just arrived at the fighter base. Describing how he destroyed a Messerschmitt-109 on his 35<sup>th</sup> combat mission in the Mediterranean area, Lieut. Lawson remarked: "This is one of the most perfect missions we've flown. We made two separate turns on the plane I got. The second time I headed for it and it seemed to be heading straight into my stream of bullets. Then it rolled over smoking and started nose down for the water."



Mildred Smith,

Lieut. Lawson is one of three AAF pilot brothers. Albert, a captain, is attached to Allied Force headquarters in the Mediterranean, and Tom, a lieutenant, pilots a B-17 with a heavy bomber group in Florida.

Bernard Hall of Snowdown and Roy Bagley of Montgomery, big cronies through high school, have both recently been made instructors. Bernard, who received his pilot's wings and second lieutenant's commission March 12 at Spence Field, was assigned to a field in Arkansas as an instructor. Roy, a corporal and an aerial gunner at the Army Air Field at Las Vegas, Nevada, writes this column:

"Have you heard my fate? This morning (March 22) my buddies left for home, en masse. I had already, bought my ticket on that 'Alabama Bound' choo choo. Friday morning the instructors' board called for me. Little did I realize that one week later my uniform would be gracing the top of a desk. The board asked me if I would like to instruct. The answer was a prompt 'No!' Two days later I was informed that Corp. Roy Bagley would remain behind with 10 others. Frankly, I was heartbroken. My heart was set on visiting Tokyo. How would you feel, Mildred? Guess I will relieve a WAC for combat. Of all things, an instructor. There are too many limited service men who can do the job."

Lieut. Elizabeth M. Campbell, Army Nurse's Corps, daughter of Mr. and Mrs. J. K. McClurkin of Cecil, was graduated a few days ago from the basic training center at Camp Rucker. A graduate of Montefiore Hospital School of Nursing in New York City, she enlisted Aug. 27, 1943.

## Information Supporting the Assumption for the Location of the Mt. Pleasant (Primitive) Baptist Church

### At Robertson's (Robinson's) Crossroads Montgomery County, Alabama

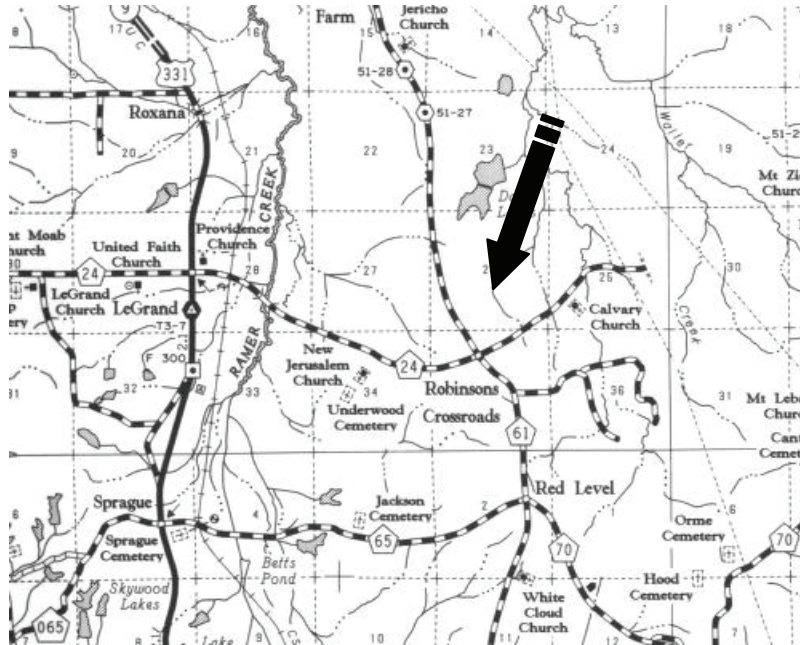

**1. REVIEW OF EARLY MONTGOMERY COUNTY, CHURCHES WRITTEN BY W. G. ROBERTSON, 1892**  
(This has been transcribed from a book titled *RECOLLECTIONS OF THE EARLY SETTLERS OF MONTGOMERY COUNTY, ALABAMA* -Original data: Robertson, W. G.. Recollections of the early settlers of Montgomery County, Alabama. Montgomery, Ala.: Society of Pioneers of Montgomery, 1961.)

#### REVIEW OF THE OLD CHURCHES IN THE COUNTY

The first Baptist church organized was in the FORK. WILLIAM ADKINS and LEMUEL FIELDS were among the first members. The next was Antioch, near Mt. Meigs. GREEN PINKSTON, JOHN and ISAAC RAY were among the first members. The next was ELAM. WILLIAM McLEMORE and a man named BREEDLOVE were among the first members. The next was Bethel, on Pintlala creek. The next was Bethlehem, in the southwestern portion of the county, and the organization is still in existence. The next was Liberty, at CARTERS HILL. The next was Mt. Pleasant. LABAN UNDERWOOD, MR. EVAN, BRIGHT SURLLES, HARDY ROBINS, and BRYANT WALTERS were among the first members.

#### **2. BRYANT WALTERS**

BRYANT WALTERS was another of those old settlers. He entered a home on the west side of Ramer creek, built his house, cleared his field, married his wife and raised his children on that farm, and never moved until his friends carried him to his final resting place. He was a member of the Primitive Baptist church, and was an honest man and a good citizen.

(This has been transcribed from a book titled *RECOLLECTIONS OF THE EARLY SETTLERS OF MONTGOMERY COUNTY, ALABAMA* -Original data: Robertson, W. G.. Recollections of the early settlers of Montgomery County, Alabama. Montgomery, Ala.: Society of Pioneers of Montgomery, 1961.)

#### **3. PERSONS COMMON TO BETHEL BAPTIST CHURCH AND TO MT. PLEASANT BAPTIST CHURCH, PROBABLY UNITING FIRST WITH BETHEL CHURCH AND LATER MT. PLEASANT.**

From Bethel Church Minutes:

**HARDY ROBINS:** Along with his wife, Mabey, joined Bethel by letter in February 1833; was asked to investigate the life of "disorder" lived by Mr. Ballew

**BRIGHT SURLS:** Joined Bethel Church June 25, 1842; dismissed October 24, 1846  
 May 27, 1843 "Bro. Bright Surlis Stated to the Conference that he was aggrieved with Bro. H.C. Howard for claiming and marking his pigs the case was taken up, and a committee of Brethren (towit) E. Jeter J. Taylor & Wm Parmer, was appointed to settle the Same and after a few minutes retirement the Said Committee reported that the case was settled."

**L.D. WALTER:** Joined the Bethel Church by experience July 27, 1845; dismissed 1848 (The minutes of the Ebenezer Baptist Association indicates that L.D. Walter was a delegate from Mt. Pleasant 1869)

**BRYANT WALTERS:** July 24, 1853 Walters was asked to look into why Dial Mills and his wife, Theodosia, had been absent so long. The couple was eventually expelled.

Side Bar: The close relationship between the two churches is indicated on January 23, 1852 when the Bethel Church was planning to license William C. Hays to preach. It was recorded that the Mt. Pleasant Church should be invited.

**4. A BRIEF ANONYMOUS TREATISE, ROBERTSON'S CROSSROADS, LATER ROBINSON'S CROSSROADS, STAMPED "COUNTY FILE-LIBRARY, DEPT. OF ARCHIVES AND HISTORY, MONTGOMERY, ALABAMA", AND ACQUIRED THROUGH RICHARD MCLANEY, states:**

*Robertson's Crossroads is named for John Robertson who lived there several years. He was a Baptist minister...The first church, Baptist, was established in this community; Laban Underwood, William Evans, Bright Surlis, Hardy Robbins, and Bryant Walters were among its first members; Rev. John Robertson, Rev. Shanks, and Rev. William Pouncy were its first pastors.*

Names	Date	Meridian	Twp-Ring	Aliquots	Sec #
Walters, Briant	8/8/1832	St Stephens	014N-018E	E1/2Se1/2	29
Walters, Bryant	8/20/1834	St Stephens	014N-018E	NE1/4Ne1/4	32

Names	Date	Meridian	Twp-Ring	Aliquots	Sec #
Robbins, Hardy H	5/2/1829	St Stephens	014N-018E	W1/2SW1/4	8
Robbins, Hardy H	8/8/1832	St Stephens	014N-018E	W1/2NW1/4	8
Robbins, Hardy H	8/8/1832	St Stephens	014N-018E	E1/2SW1/4	8
Robbins, Hardy H	11/14/1833	St Stephens	014N-018E	E1/2NW1/4	17

Names	Date	Meridian	Twp-Ring	Aliquots	Sec #
Underwood, Laban B	6/4/1833	St Stephens	014N-018E	E1/2SW1/4	27
Underwood, Laban B	8/20/1834	St Stephens	014N-018E	E1/2SW1/4	34
Underwood, Laban B	5/15/1837	St Stephens	014N-018E	E1/2NW1/4	34

**CONCLUSION:** While the split between the missionary and primitive branches of the Baptist Church was regional, it was formalized in the meeting of the Alabama Baptist Association at the Bethel Baptist Church in 1837. Other churches, once missionary, identified with the Primitive Baptist movement. Churches which officially embraced the theology of Primitive Baptists withdrew from the Alabama Baptist Association and formed the Ebenezer Baptist Association. Shortly after the division, those previously named who lived in and around Robertson's Crossroads traveled once each month to Pintlala, approximately 5-6 miles away to worship. After the Mt. Pleasant Church was established, the same individuals eventually transferred their memberships to Mt. Pleasant, only 3 miles east of LeGrand. Neither church exists today.



**PINTLALA HISTORICAL  
ASSOCIATION**

*c/o Pintlala Public Library  
255 Federal Road  
Hope Hull, AL 36043*

**NEXT MEETING**

**JANUARY 15TH, 2012  
2:30 P.M.**

**PINTLALA BAPTIST  
CHURCH**

Join the Pintlala Historical Association  
Please mail completed form, fee & dues to :

**Pintlala Historical Association  
Ina Slade  
15212 Highway 31  
Hope Hull, Alabama 36043**

Name \_\_\_\_\_

Address \_\_\_\_\_

City, State Zip \_\_\_\_\_

Phone (Home & Office) \_\_\_\_\_

E-Mail Address \_\_\_\_\_

Areas of Interest \_\_\_\_\_

If you are interested in genealogy, please indicate family surnames \_\_\_\_\_

**\$15.00 Annual Dues**